

Hummingbird Lite

Quick Installation and Maintenance Instructions



Medical Facility Responsibility

Preventive maintenance checks must be performed regularly to maintain the quality and performance of this product. Any parts that may be broken, missing, worn, distorted, or contaminated in any way should not be used and all affected parts should be replaced immediately. Should the necessity of any repair be suspected; please contact your local distributor.



WARNING: It is the responsibility of the end user to ensure all aspects of installation are covered by following the full manual and reviewing warnings/notes found at:
<http://www.amico.com/products/computer-workstations/mobile/non-powered/hummingbird-lite-laptop>.



WARNING: An assembly walk-through video is also available here:



Installation Tools

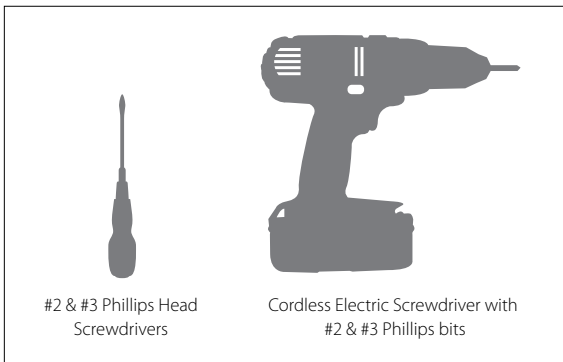

Installation Reference

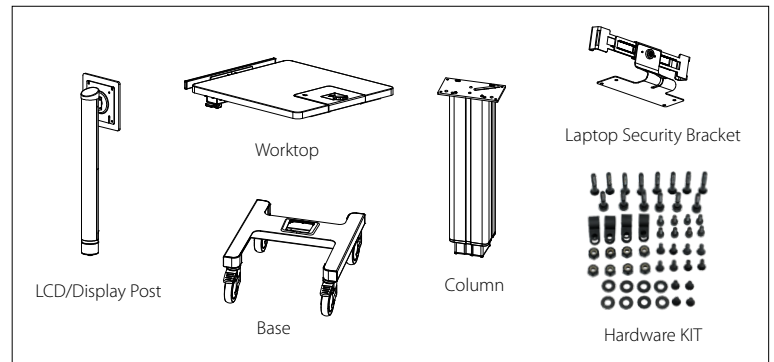

A hardware kit for each component can be found taped to the component (e.g. hardware kit to secure base to column is found taped to the base).



4x Phillips Pan Head
1/4 - 20UNC 1" Length



4x Phillips Pan Head
8 - 32UNC 9/16" Length



1x Phillips Pan Head
10 - 24UNC 1/2" Length



4x Phillips Pan Head
1/4 - 20UNC 1/4" Length



10x Phillips Pan Head
8 - 32UNC 3/16" Length

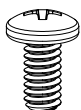

4x Phillips Pan Head
1/4 - 20UNC 1/2" Length



4x Phillips Pan Head
1/4 - 20UNC 3/8" Length



4x #10 Washer



4x #14 Washer



4x #14 Lock Washer



4x Hex Acorn Cap Nut
10 - 24UNC



1x Spacer/Stopper



4x Reusable Zip Ties



12x Dual Lock Pad

Hummingbird Lite

Quick Installation and Maintenance Instructions



Instructions

1. Unpack **Box 1/2** as per the instruction layout printed on the inside flap and **Box 2/2** as per the instruction layout printed on the top of the box.

2. Place **BASE** with casters on the ground (**Figure 2**). Secure in place by engaging the brakes on the front casters.

3. Join the **COLUMN** in **Box C** with the **BASE** by sliding the **COLUMN** into the opening on top of the **BASE** (**Figure 3**), and fasten 4x **1/4 - 20 x 1" LONG SCREWS**, 4x **#14 LOCK WASHERS**, and 4x **#14 WASHERS** through the bottom of the **BASE** into the **COLUMN** (**MOUNTING KIT** taped inside the **BASE**). Ensure the bottom of the vertical **COLUMN** is placed inside the collar (pre-installed in opening). You might find it easier to do this step with the **BASE** on its side - use the **COLUMN** box (**Box C**) to support the **COLUMN** if necessary.

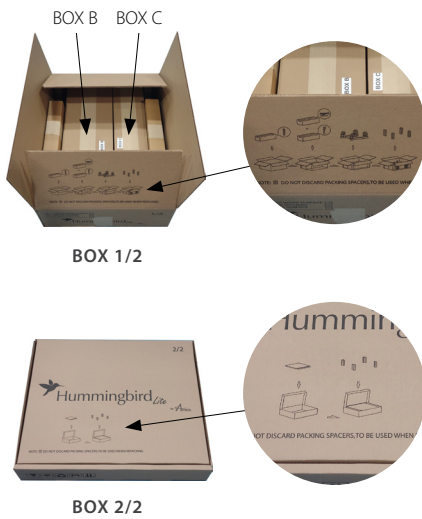

Figure 1

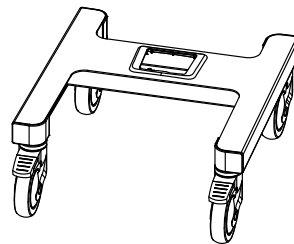

Figure 2

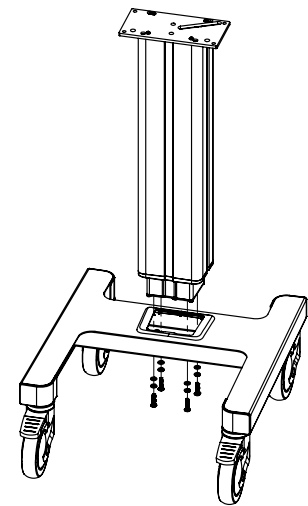

Figure 3

4. Place the **WORKTOP** (**Box 2/2**) on the **COLUMN** top plate and fasten 4x **1/4 - 20 x 3/8" LONG SCREWS** (**HARDWARE KIT** taped to top of **COLUMN**) (**Figure 4**). Fit the lever housing to the **WORKTOP** with 4x **1/4 - 20 x 1/2" LONG SCREWS** (**HARDWARE KIT** taped to lever housing). (**Figure 5**)

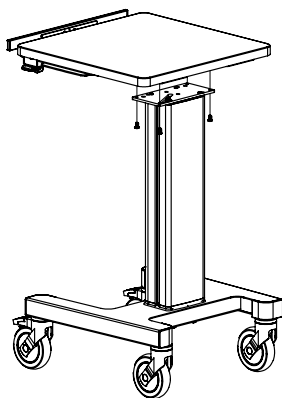

Figure 4

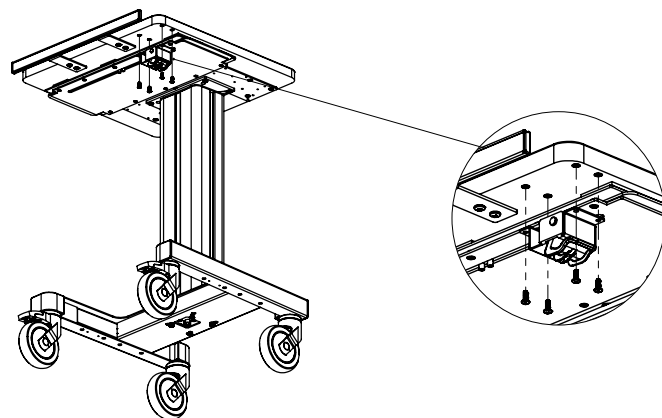

Figure 5

Hummingbird Lite

Quick Installation and Maintenance Instructions



Instructions

4a. **LAPTOP SECURITY BRACKET MODELS:** Install the **LAPTOP SECURITY BRACKET (Box B)** to the **WORKTOP** by placing the **LAPTOP SECURITY BRACKET** on the back of the **WORKTOP** and fastening 4x **1/4 - 20 x 1/4" LONG SCREWS (MOUNTING KIT** taped to bracket) from the bottom. (Figure 6)

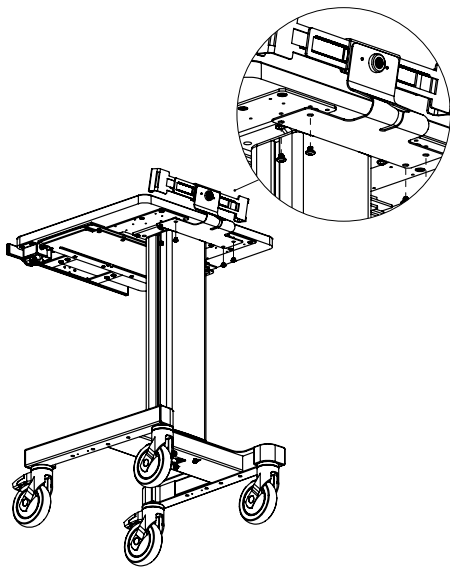

Figure 6

4b. **LCD/DISPLAY POST MODELS:** To attach the **LCD/DISPLAY POST (Box B)** to the **WORKTOP**, first place the **BRACKET** in **Box B** on the **WORKTOP** bottom and fasten 4x **1/4 - 20 x 1/4" LONG SCREWS (Figure 7)** from the bottom (**HARDWARE KIT** taped to **BRACKET**). Carefully insert the **LCD/DISPLAY POST** through the **WORKTOP** opening on the top and align with the bracket hole. Fasten with 4x **8 - 32 x 9/16" LONG SCREWS (HARDWARE KIT** taped to **LCD/DISPLAY POST**). (Figure 7)

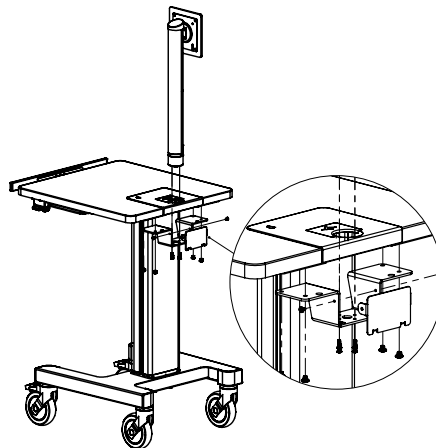

Figure 7

4c. **SLIDING KEYBOARD TRAY MODELS:** Slide the **KEYBOARD TRAY BRACKET** in (**Box B**) into the **WORKTOP KEYBOARD TRAY TRACK (Figure 8)** and insert 10 - 24 x 1/2" **LONG SCREWS** through **SPACER/STOPPER** into **KEYBOARD TRAY TRACK** to secure. Remove the bottom **ACORN NUTS** and **#10 WASHERS** from the sliding **KEYBOARD TRAY (Box 2/2)** and align with **KEYBOARD TRAY** bracket holes. Fasten back **#10 WASHER** and **ACORN NUTS**. (Figure 8)

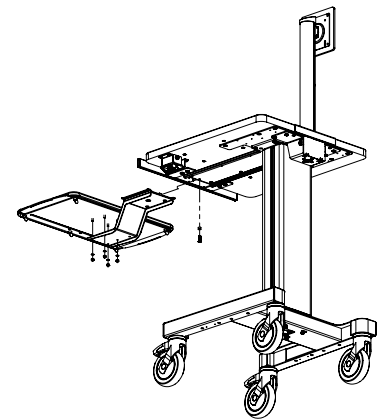

Figure 8

Attaching Accessories

1. **POWER CORD HOOK/POWER CORD + BARCODE SCANNER HOOK:** Install the hook (**Box B**) to the **WORKTOP** bottom plate with 2x **8 - 32 x 3/16" LONG SCREWS (HARDWARE KIT** taped to hook). (Figure 9)

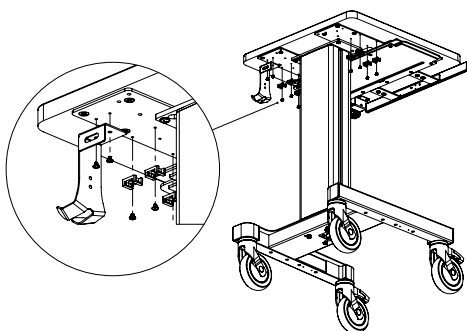

Figure 9

2. **POWER SUPPLY/POWER BAR:** The cart has **ZIP TIE** saddles on the left and right underneath the **WORKTOP** for securing power supplies or power bars. Slide a **ZIP TIE** (found with **WORKTOP**) through each saddle slot (Figure 10). Place the power bar or power supply within the 2x **ZIP TIES** and secure.

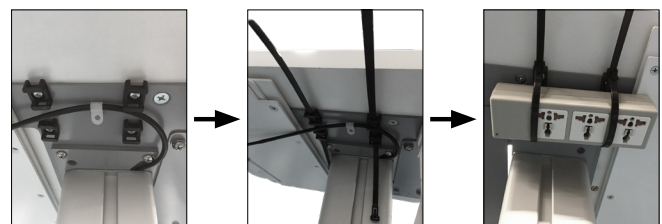

Figure 10

Hummingbird Lite

Quick Installation and Maintenance Instructions



Specifications and Adjustments

Refer to the Amico website for the manual and specification documents.

Troubleshooting Guide

Problem	Possible Cause	Solution
LCD mount facing wrong direction.	Incorrect installation.	Check the LCD/display post hole positions, should keep the LCD mounting facing front with 180° hole pattern.
Loosened worktop.	Improper installation or loose connection.	Check the screws between worktop and column plate, should be tightly secured.
Sliding keyboard tray falls off.	Forgot to install the stopper.	Make sure stopper is always installed.
Laptop adjustable clamp is not opening.	Missing key.	Locate the key or contact Amico Accessories.
Too easy or too difficult to utilize the portrait/landscape feature.	Damaged hardware.	Please contact Amico Accessories.
The display mount is not secure, it is wobbling or loose when using the portrait/landscape feature.	Damaged display mount.	Display mount needs to be replaced. Please contact Amico Accessories.
Monitor drifts down.	Incorrect gas spring in LCD/display post.	Please contact Amico Accessories.

Maintenance

It is recommended that once every three (3) months, all locks, bolts, and screws are visually inspected for signs of product wear and tear or damage. Check the product for looseness in the mount or orientation, and ensure the adapter is secure.

Warranty

During the term of warranty: Within the first twelve (12) months from the date of shipment, Amico Accessories will repair or replace any part which is proven to be defective at no cost. After the twelve (12) month period, Amico Accessories will send the parts to the customer free of charge, however shipping and installation will be borne by the customer.

Amico Accessories Inc. will warrant its materials to be free from defect for an additional period of four (4) years, (five [5] years from the date of shipment). Within this period, Amico Accessories Inc. will replace any part which is proven to be defective, at no charge. Shipping and Installation costs after the first twelve (12) months will be borne by the Customer.

The warranty is valid only when the product has been properly installed according to Amico Accessories specifications, used in a normal manner, and serviced according to factory recommendations. It does not cover failures due to damage which occur in shipments or failures which resulted from accidents, misuse, abuse, neglect, mishandling, alteration, misapplication or damage that may be attributable to Force Majeure.

Amico Accessories Inc. shall not be liable for incidental or consequential damages resulting from use of equipment.

All claims for warranty must first be approved by Amico Accessories Inc. A valid Return Goods Authorization (RGA) number must be obtained from Amico Accessories Inc. prior to commencement of any service work. Warranty work, which has not been preauthorized by Amico Accessories Inc., will not be reimbursed.

AMICO ACCESSORIES DOES NOT HONOR VERBAL STATEMENTS CONCERNING THE WARRANTY.

The distributor and/or dealer are not sanctioned to create verbal warranties about the product described in this agreement. Any statements will not be honored or be made part of the agreement of sale. This document is the final complete and exclusive terms of the agreement.

THIS WARRANTY IS INCLUSIVE AND REPLACES ALL OTHER WARRANTIES.

Amico Accessories shall not, under any circumstances be liable for incidental or consequential damages including, but not limited to, profit, loss of sales or injuries to person(s) or property.

Correction of non-compliance as noted above will result in completion of all liabilities of Amico Accessories whether based on agreement, neglect or changed materials, designs or specifications without notice.

All claims for warranty must first be approved by Amico Accessories Inc. Service Department: accessories@amico.com or 1.877.264.2697. A valid Return Goods Authorization number must be obtained from Amico Accessories Inc. prior to commencement of any warranty claim.