

PHILIPS COMPATIBILITY



Intelliview MP20, MP30, MP40, MP50, MP60, MP70, MX400, MX450, MX500, MX550, MX600, MX700, MX800

Amico Quality – 25 Years of Expertise

- Amico meets and/or exceeds IEC 60601 medical electrical device standards
- Amico has a 5 year warranty on all products
- Amico is certified to the ISO 13485:2016 quality standard for medical devices
- Amico manufactures complex products meeting the rigid standards of FDA, OSHPD, NFPA, ISO, CSA, and UL where required (visit www.amico.com for a list of products and listings)
- Installation of Amico mounting solutions are as simple as those of Philips and take less time



Intelliview MX450
on Direct Mount AHM

Install with Ease

TABLE TOP MOUNT M8000-64100

Provided by Philips

Before assembly, please lock the shelf to a desired angle. $\pm 15^\circ$ recommended

Using the hardware provided by Philips, fasten table top mount to the shelf.

Place monitor on the table top mount

Re-adjust the tension as needed

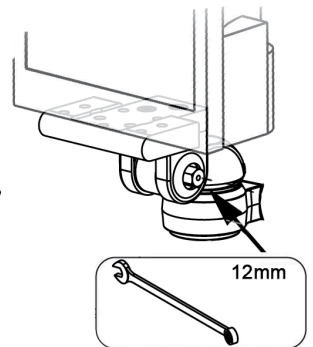
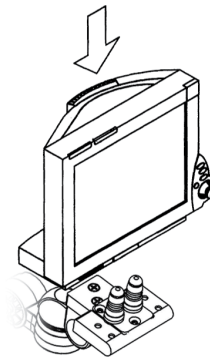
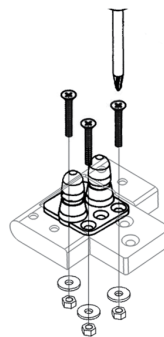
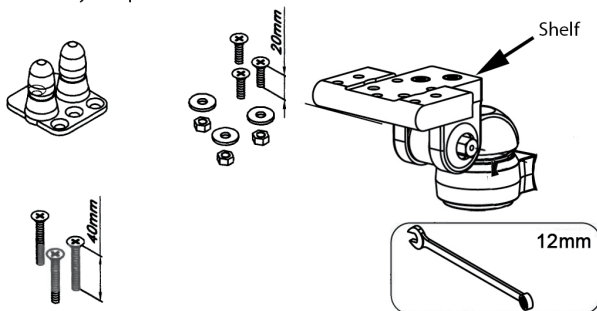

Let Us Help You

- Send us the Philips table top mounts in advance and we will pre-install them at the factory
- Provide us with the Philips model number and we can counter balance the arm at the factory
- We will label the boxes in accordance to specific room and bed numbers



5YEAR
warranty

INSTALLATION SITES USING AMICO ARMS



for Philips MP, MX and VS Series Monitors

N.Y. City Health & Hospital Corporation
Bon Secours Harbour View Medical Center
Highlands Regional Medical Center
Shands Hospital
Saint Joseph Mercy Health System
Metro Health Hospital
Saint Francis Health System
Bristol Regional
Long Island Hand Center

Holston Valley Medical Center
Swedish Medical Center
Collier Regional
Methodist Hospital
Mercy Hospital
Coral Gables Hospital
Lonesome Pine Hospital
Beaufort County Hospital
Pitt County Memorial Hospital

St Mary Hauenstein Center
Treasure Cove Surgery Center
Baptist Health
Sunnybrook Hospital
Medical Center Of Central Georgia
Children's Hospital of L.A.
Glendale Adventist
El Camino Hospital



CERTIFICATE OF REGISTRATION

This is to certify that the management system of:

Amico Accessories

Main Site: 122 East Beaver Creek Road,

Richmond Hill, Ontario L4B 1G6, Canada

has been registered by Intertek as conforming to the requirements of:

ISO 13485:2016

The management system is applicable to:

Design and manufacturing of components for mounting solutions designed to provide physical supports to medical devices.

Certificate Number:

0044465-02

Initial Certification Date:

23 March 2016

Date of Certification Decision:

28 February 2022

Issuing Date:

22 March 2022

Valid Until:

22 March 2025



The SCC Accreditation Symbol is an official symbol of the Standards Council of Canada, used under licence.

intertek

Calin Moldovean

President

Intertek Testing Services NA Ltd.,
1829, 32nd avenue, Lachine, QC, H8T 3J1,
Canada



SINAI SCENE

JUNE 15, 2012

Big Technology to Help Our Smallest Patients



Photo courtesy of Salena Mohammed

The team from Mount Sinai Hospital, Philips and Amico worked for two days to successfully install the high-tech monitors.

A new generation of high-tech physiological monitors will revolutionize the way tiny babies are cared for in the Neonatal Intensive Care Unit (NICU) and Level 2 Nursery.

The Cardio Respiratory Patient Physiological Monitors have cutting-edge technology that can not only monitor basic vital signs, but can monitor the intricacies of a baby's heart rate wave form, measure the amount of oxygen in their blood, respiration, blood pressure (arterial) and temperature, among other critical vital signs.

"As the needs of our tiny patients become more complex and more acute, we need the technology to help assist our clinicians to deliver the best care — and Mount Sinai is all about providing the

best care. This was a great step forward for our unit and the entire Hospital," said Salena Mohammed, Nursing Unit Administrator for the NICU.

For Mohammed, the planning and organization to bring the monitors to the Hospital was three years in the making. Shortly after she began working at Mount Sinai, Mohammed and her team realized that enhanced technology could benefit both patients and clinicians. With the new monitors, clinicians now have a better way to review critical incidences and look for vital sign trends, which can help tailor care plans to meet the needs of the baby. For example, a nurse can look at the data to see what happens to the baby when he or she is fed or is given a certain medication.

When the new monitors arrived on May 15, an energetic team made up of NICU Nursing, Biomedical Engineering, Respiratory Therapy, as well as a team from Philips (providers of the monitors) and Amico (providers of the arms that help mount the new technology), installed 61 monitors over two days with no disruption to patient care.

"It was amazing. Every person knew what their job was for that day. There was staff moving old equipment out, biomed drilling holes, housekeeping personnel to clean the space. It was like an assembly line," said Mohammed, who added Phuong Nguyen, an NICU RN, played a key role in monitoring and transitioning the babies as the equipment was installed at the bedsides.

In a few short weeks, Mohammed already notices an impact. The team is more comfortable moving about the space because the monitors are larger, clearer and can be seen from almost any angle. It is easier for clinicians to communicate to parents about their baby's condition, as nurses and doctors can explain what the colour coding means on the machines. With more information, families feel more comforted.

"We are truly offering family-centred care. Parents are able to see and understand what is happening with their baby and this brings some relief," Mohammed added.