

Falcon IT (FIT)

Quick Installation and Adjustment Instructions



Medical Facility Responsibility

Preventive maintenance checks must be performed regularly to maintain the quality and performance of this product. Any parts that may be broken, missing, worn, distorted, or contaminated in any way should not be used and all affected parts should be replaced immediately. Should the necessity of any repair be suspected; please contact your local Amico distributor.



WARNING: It is the responsibility of the end user to ensure all aspects of the installation are covered by following the full manual at: <https://www.amico.com/sites/default/files/product/downloads/amico-aa-wall-mounted-computer-workstation-falcon-manual.pdf>

Installation Reference and Tools

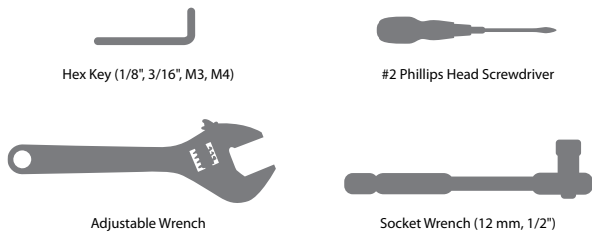
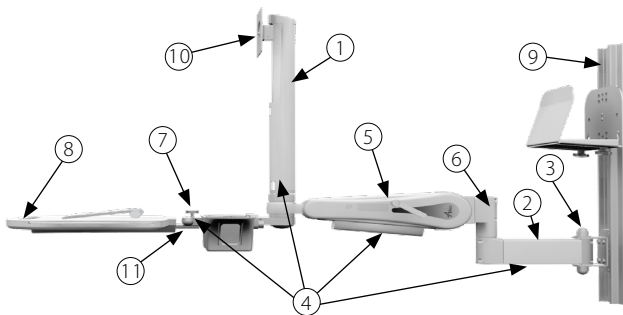

FIT

- Swivel Post**
For mounting and positioning of monitor.
- Extension Arm**
Extension arm to increase movement range of AHM ARM (if applicable).
- Mounting Adapter**
Different mounting adapters will be provided based on the rail system used.
- Cable Management**
Manage cables for the FIT station for a clutter-free environment.
- Height-locking Lever**
Locks arm at the desired height.
- Counter-balance Bolt**
Balance the weight of the monitor on the AHM ARM of the FIT.
- Negative Tilt Knob**
Tilts the keyboard tray's back downwards for proper ergonomics in certain cases.
- Keyboard Tray**
Location for keyboard & mouse. (2x mouse pads, 12x dual lock coins provided; wrist rest if purchased).
- Rail System**
For mounting the FIT station, varies depending on user's selection. Rail is packed separately and must be installed first.
- VESA Head**
For mounting the monitor.
- Mouse/Scanner Holder**
For storing mouse and hand-held scanners.

1. Installation to Structure

Mounting on an MRS Rail
4x 1/4-20 SET SCREWS. Use 1/8" (3 mm) Hex Key to tighten.

WARNING: Never attempt to mount or remove the AHM ARM from the MRS RAIL when a monitor is installed.

WARNING: Support AHM ARM until the SET SCREWS are tightened, AHM ARM can slide down when SET SCREWS are not tightened.

Mounting on a VRS/Ohmeda Rail
Angle the AHM ARM from the left of the CHANNEL and guide the ADAPTERS into the groove of the CHANNEL. Tighten SCREW with a 3/16" Hex Key when V-ADAPTER is at the desired height. When tightened, the SCREW will protrude from the other side. Fasten the NUT to the SCREW to secure the V-ADAPTER. If the NUT cannot be installed, the ADAPTER is not properly engaged. Check that all NUTS and SCREWS are tightened to ensure the V-ADAPTER is locked.

Mounting on a Headwall
Pop out the cover from the MOUNTING ADAPTER CHANNEL to access the SCREWS. Remove the 2x SCREWS and LOCK WASHERS to free bottom MOUNTING ADAPTER. Install it into the bottom RAIL by angling the upper lip into the inside lip of the ARS RAIL, pull the lever back against the MOUNTING ADAPTER and push the ADAPTER into the ARS RAIL. Once secure, release the lever. Install the remaining MOUNTING ADAPTER into the top ARS RAIL the same way as step 1, ensuring the 2x HOLES in the bottom MOUNTING ADAPTER can be seen through the MOUNTING ADAPTER CHANNEL. Secure the CHANNEL to the bottom MOUNTING ADAPTER using the SCREWS and LOCK WASHERS you removed in step 1.

2. Installation to Monitor

- Determine the monitor mounting configuration. VESA 75 (75 mm x 75 mm M4 thread) or VESA 100 (100 mm x 100 mm M4 threads).
- VESA 100 Configuration:** 2x SCREWS are partially threaded into the top 2x HOLES in the back of the monitor. The monitor can then be hung up on the VESA HEAD through the 2x slots at the top. Insert 2x more SCREWS through the VESA 100 MOUNTING HOLES at bottom, tighten all SCREWS. (Figure 1)
- VESA 75 Configuration:** Rotate the VESA HEAD so the 2x slots for the VESA 75 configuration are located at the top. Partially thread 2x SCREWS into the top 2x HOLES in the back of the monitor. The monitor can then be hung up on the VESA HEAD through the 2x slots at the top. Insert 2x more SCREWS through the VESA 100 mounting holes at the bottom and tighten all SCREWS.
- When removing the monitor, the monitor ARM and the monitor should be placed at the highest position (Figure 2). Remove the 2x bottom SCREWS from the VESA PLATE, loosen the top 2x SCREWS, and lift the monitor off the VESA PLATE.

NOTE: 4x M4 SCREWS are provided for mounting the monitor to the VESA HEAD, different SCREWS may be needed if the provided SCREWS are not the right size, standoffs may be needed depending on the hole pattern on the monitor.

WARNING: Ensure that the AHM ARM is in the highest vertical position and locked before mounting or removing devices from the FIT station.

Falcon IT (FIT)

Quick Installation and Adjustment Instructions



3. Rotation (AHM Side-to-side)

TO ROTATE AT FIRST ARM

EXTENSION ARM ROTATED

ROTATE END POINT

TO ROTATE AT SECOND ARM
TO ROTATE AHM ARM:

SECOND ARM ROTATED

ROTATE MID POINT

WARNING: In AHM ARM(s) with extensions, both arms have a 180° rotation. Ensure proper clearance around the arm(s) to avoid collision (if applicable).

4. Head Tilt and Rotation

Figure 1

Figure 2

The monitor can swivel 360° (clockwise/counter-clockwise, left/right), it can also tilt up/down by +/- 15°.

Adjusting Tilt Tension: Tighten or loosen the **LARGE SCREW** on the **MOUNTING BRACKET** and then tighten or loosen the 2x **SMALL SCREWS** to fine tune the tension. **(Figure 1)**

Adjusting Swivel Tension: Slightly (one turn) loosen/tighten the **COUNTER-BALANCE BOLT** at the base of the **KEYBOARD TRAY**, to adjust the rotational tension of both the monitor and the **KEYBOARD TRAY**, slightly loosen/tighten the 3x **PHILLIPS HEAD SCREWS** at the base of the **KEYBOARD TRAY**. **(Figure 2)**

WARNING: Be sure to support the monitor if adjusting the tilt angle with the monitor mounted.

WARNING: After the monitor is installed, tighten large and small tilt adjustment **SCREWS** to the tightest position possible with the weight of the monitor attached. Alternate between tightening **LARGE SCREWS** and **SMALL SCREWS** until the appropriate tension is reached.

5. FIT Post Cable Management

- There are 2x **FIT CABLE GUIDE CHANNELS** in the **SWIVEL POST**, which is covered by the **SWIVEL POST CABLE COVER**.
- Pop out the **SWIVEL POST CABLE COVER**, take your power cable for your all-in-one and place the cable gently into the **GUIDE CHANNELS** towards your **AHM ARM** (**Figures 1 & 2**). Take your cables from the keyboard tray and place the cables into the **GUIDE CHANNELS** towards your all-in-one.

WARNING: Do not bunch cables together in one **CABLE GUIDE CHANNEL**. Use separate **CHANNELS** for each cable.

Figure 1

Figure 2

Figure 3

6. Height Locking Lever Adjustments

INSERT HEIGHT LOCKING LEVER

HEIGHT LOCKING LEVER:
ROTATE COUNTER-CLOCKWISE TO RELEASE, ROTATE CLOCKWISE TO LOCK.

To adjust the **AHM ARM** height, always be sure to loosen the **HEIGHT LOCKING LEVER** first.

7. Counter Balance

HEIGHT LOCKING LEVER
COUNTER-BALANCE BOLT (1/2")

Loosening or tightening the **COUNTER BALANCE BOLT** will adjust the resistance of the **AHM ARM**.

COUNTER-BALANCE BOLT (1/2")
OPENING TO THE COVER

When properly counter-balanced, the **AHM ARM** should remain in neutral position when unlocked.

COUNTERBALANCE ADJUSTMENT

NOTE: Do not over rotate the **COUNTER-BALANCE BOLT**. Once you feel resistance, stop counter-balancing. Forcing the **COUNTER-BALANCE BOLT** will damage the internals of the **AHM ARM** and void the warranty.

WARNING: KICK-BACK MOTION: when the **AHM ARM** is locked and not in the highest position, it is capable of rapidly lifting to the highest position once the **HEIGHT LOCKING LEVER** is released.

8. Cable Management

Insert cables into **CABLE GUIDE**, then squeeze **CABLE GUIDE** and press onto the bottom of the **AHM ARM**.

CABLE GUIDE → **BOTTOM SIDE OF CABLE COVER**

GROOVES
BOTTOM SIDE OF THE AHM ARM

CABLE COVER

CABLE GUIDE
BOTTOM SIDE OF THE AHM ARM