

# Retro-Fit Manual

# Ohmeda Gas Control Panel











# Important Note

Due to unknown factors of the existing equipment, projects requiring Retro-Fit Conversions must be fully investigated by the installer.

It is the responsibility of the installer to determine if the Retro-Fit will function correctly and if additional components are required. Amico is not responsible for any additional components required.

## Retro-Fit Instructions

<p>Remove the screws from the Ohmeda Gas Control Panel.</p>	
<p>Remove all internal components.</p>	
<p>After removing all internal parts, the only part left in the box should be the 5/16" male fittings for the input and output.</p>	
<p>Mount the filler frame to the wall using the appropriate hardware. There are 6 holes provided for mounting the frame; 3 on top, 3 on the bottom. <b>NOTE:</b> The frame cannot be mounted on the wall centered on the existing back box. The retrofit is shipped with the filler frame attached to the control panel. Before you take these apart, push the assembly into the existing back box, position it in place and mark off the corners of the frame on the wall. These lines will be your reference for mounting the frame to the wall.</p>	
<p>This is the input pigtail; it is already secured to the Amico Control Panel. Secure these fittings to the female end of the pigtail.</p>	
<p>The pigtail that is supplied separately with the retrofit kit is for the output. Secure these fittings to the male end of the pigtail. The female end should be secured to the output on the back of the Amico Control Panel.</p>	
<p>Secure the input and output pigtails to the existing connections in the back of the Ohmeda box. Please refer to the next picture for the correct position of the pigtails.</p>	
<p>This should be the position of the pigtails as the Amico control panel is positioned into place and secured to the filler frame. It is very important that the pigtails be situated this way to give them enough room to flex, otherwise it is possible that the pigtail might kink.</p>	

# Diagrams

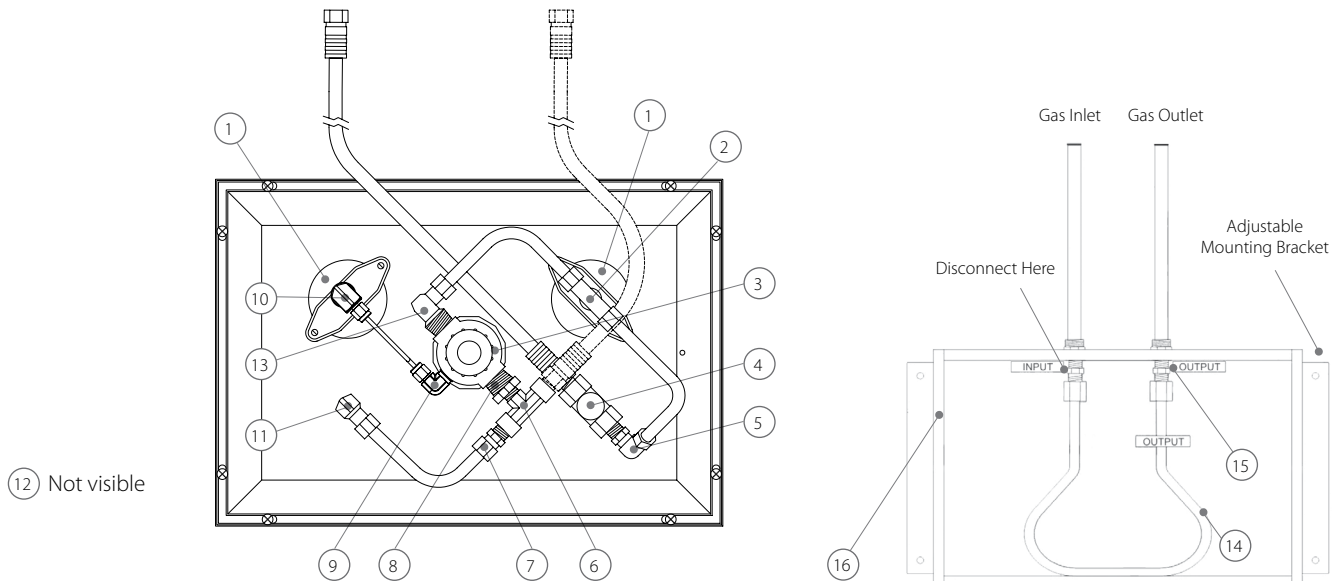

## Repair kit part #: N-X-TUBE-KIT

\* Item numbers with \* is included in the repair kit with 1 set of copper piping.

Item	Description	Part Number
1	2 1/2" Gauge, 0-400 psi, 1/4" Center Back Mount	M-X-MAN-52B
2*	Brass Tee 1/4" FNPT* 3/8" Tube	N-X-TEE-AL-F304
3	Regulator Relieving	N-X-REGULATOR-R
4	Shut-off Valve (Brass)	N-X-VALVE
5*	Elbow 90° 3/8" MNPT* 3/8" Tube	N-X-ELBW-AL-M37
6	Brass Tee 1/4" FNPT* 3/8" Tube	N-X-TEE-AL-F304
7*	Connector 3/8" MNPT* 3/8" Tube	N-X-CON-AL-375
8	Bushing 1/2" * 3/8"	N-X-BUSH
9*	Elbow 90° 1/4" MNPT* 1/8" Tube	N-X-ELB-ALM2508
10*	Elbow 90° 1/4" FNPT* 1/8" Tube	N-X-ELB-ALF2508
11*	Elbow 90° 1/4" FNPT* 3/8" Tube	N-X-ELBOW-AL
12a	DISS Demand Check Valve 1/4" MNPT - Nitrogen	S-DIS-DEMC-NIT
12b	DISS Demand Check Valve 1/4" MNPT - Instrument Air	S-DIS-DEMC-IAIR
13*	Elbow 90° 1/2" MNPT* 3/8" Tube	N-X-ELBW-AL-305
14	18" Long Braided Pigtail (3/8" inner diameter)	N-X-PIGTAIL
15	Pigtail/Pipe Adapter for Nitrogen Control Panel	N-X-PT-ADAPTER
16	Box for Nitrogen Control Panel	N-X-BOX

# www.amico.com

Amico Corporation | 85 Fulton Way, Richmond Hill, ON L4B 2N4, Canada  
600 Prime Place, Hauppauge, NY 11788, USA  
Toll Free Tel: 1.877.462.6426 | Tel: 905.764.0800 | Fax: 905.764.0862  
Email: [info@amico.com](mailto:info@amico.com) | [www.amico.com](http://www.amico.com)

