

Freestanding Track

Specifications



Specifications:

The freestanding track is a load bearing portable track set up that can be moved around from room to room as required.

The freestanding track is designed to be used with either the GoLift 400 or the GoLift Portable 450. The stand comes as five separate pieces that requires a 5/16" Allen Key to set up.

- Maximum capacity: 450 lbs
- Set up time: 5 minutes
- Compatible with any Amico trolley
- 4-point contact design for auto leveling on uneven flooring
- Handset charging compatible, optional wall mounted dock charging station available separately
- Does not come with charger
- No maintenance or servicing required

WARNING: the stand must be used on level ground (do not use on an angle). The lift must only be operated while the patient is on the inside of the outer frame of the stand on either side.

Dimensions:

Dimensions shown in mm/in

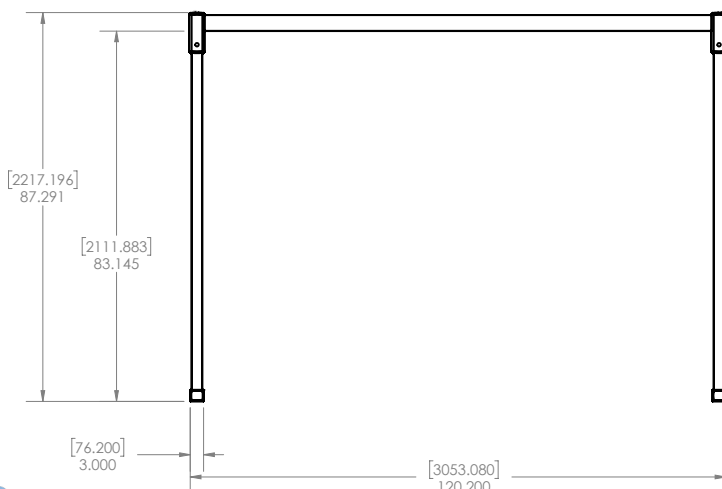

Part Numbers:

- 87" Height, 120" Length: TRK-PORT-80-120-ASSY
- 99" Height, 120" Length: TRK-PORT-92-120-ASSY
- 87" Height, 135" Length: TRK-PORT-80-135-ASSY
- 99" Height, 135" Length: TRK-PORT-92-135-ASSY
- 87" Height, 149" Length: TRK-PORT-80-149-ASSY
- 99" Height, 149" Length: TRK-PORT-92-149-ASSY

NOTE: Must follow maximum span chart:
135" for 450 lbs & 149" for 400 lbs
(custom length available upon request)

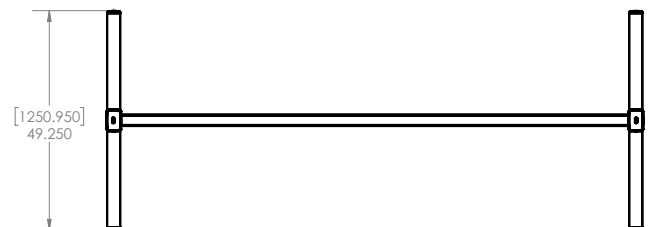

How to Assemble

Recommended: Two People

Tools: 5/16" Allen Key

Step 1:

Line up the holes in the foot with the threaded holes on the post and use the 3/8 - 16 x 1" long socket cap screw, washer, and lock washer to secure the foot to the posts.

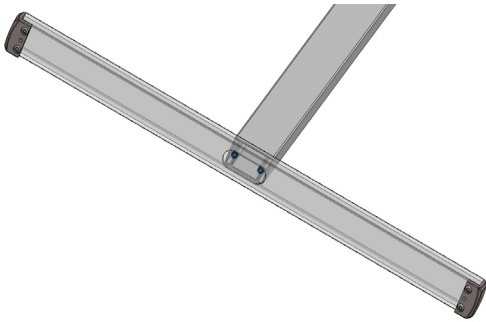

Step 2:

Stand the two posts up and drop the track assembly (shown in blue) onto the two posts.

Note: The tracks must be straight, the fit is tight.

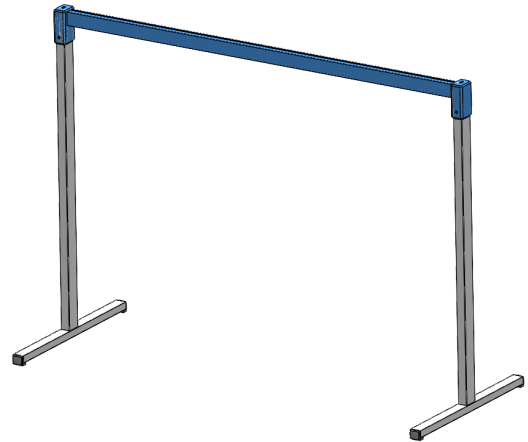

Step 3:

Align the mounting holes in the post and the track assembly, and use the 3/8" socket cap screws on either side to secure the track assembly to the posts. Press the caps over the screws to hide them from view.

